



# 3Dsurvey Pilot APP on integrated screen of Phantom 4 PRO +

15.04.2019

[Overview](#)

To run the 3Dsury Pilot APP on integrated screen of DJI drones you need to download the APK file from <https://www.3dsurvey.si/support/downloads>.

Below you can find the detailed workflow descriptions for the App installation.

## Workflow:

Turn on the Drone RC and be sure that you are connected to a Wifi network with your device. Click on the "hamburger menu" button:

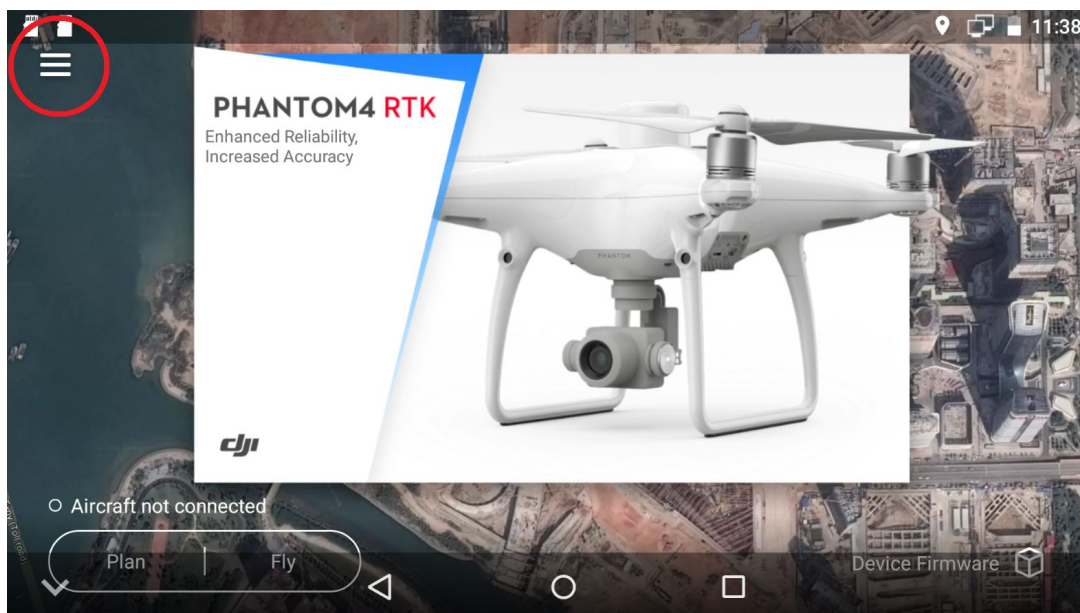

Select Setting button:

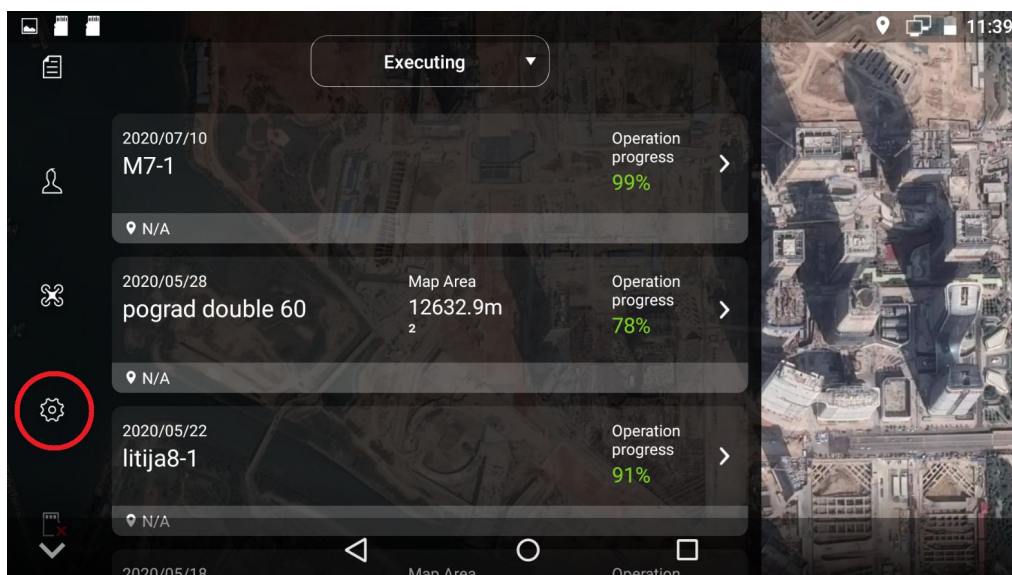

Select Apply to All and open Browser:

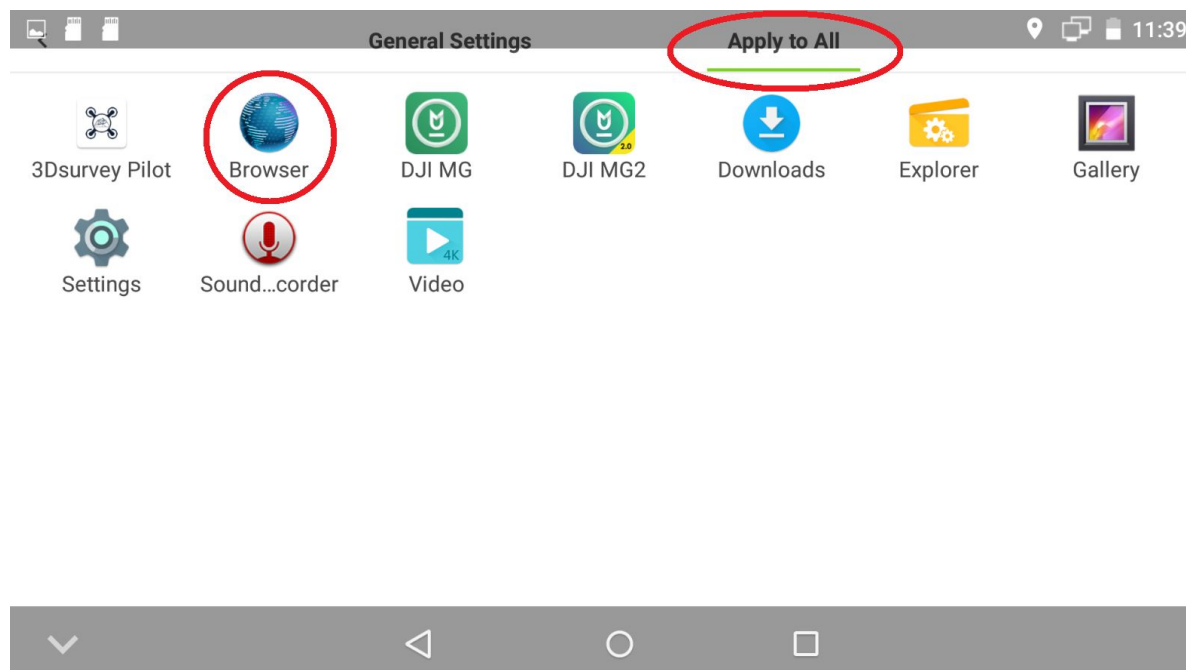

Google for [www.3dsurvey.si](http://www.3dsurvey.si) and go for: -> Sign in with your 3Dsury account -> go for Downloadables and select 3Dsury Pilot Android APK.

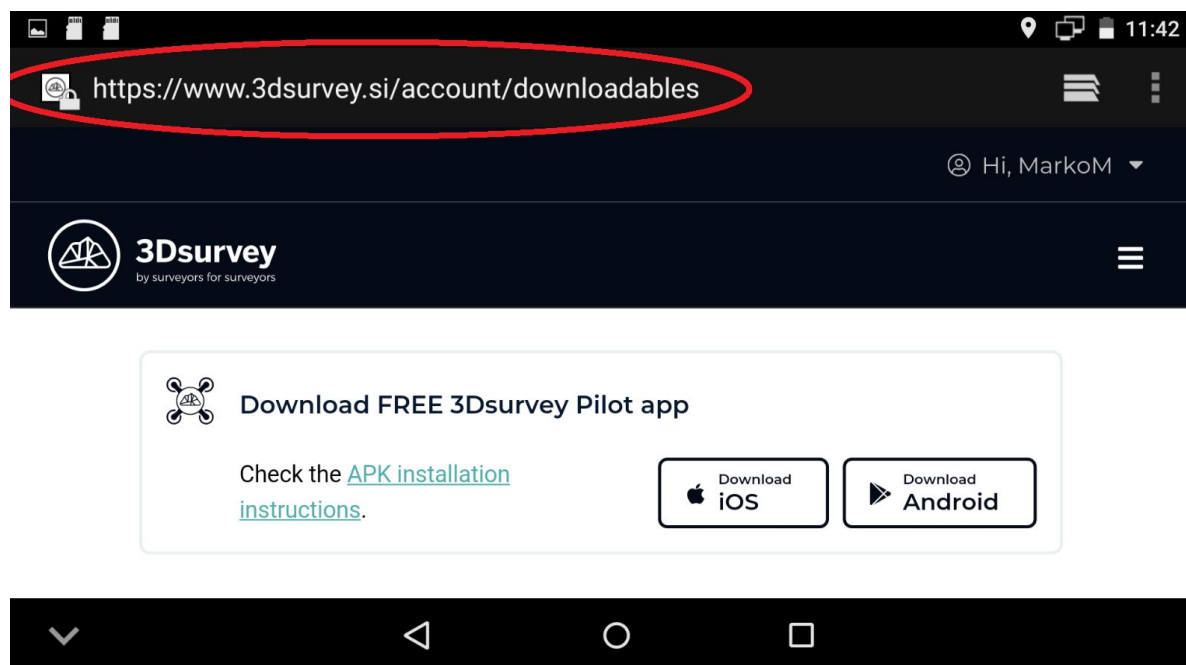

After the finished download go to All Applications window and open Explorer app:

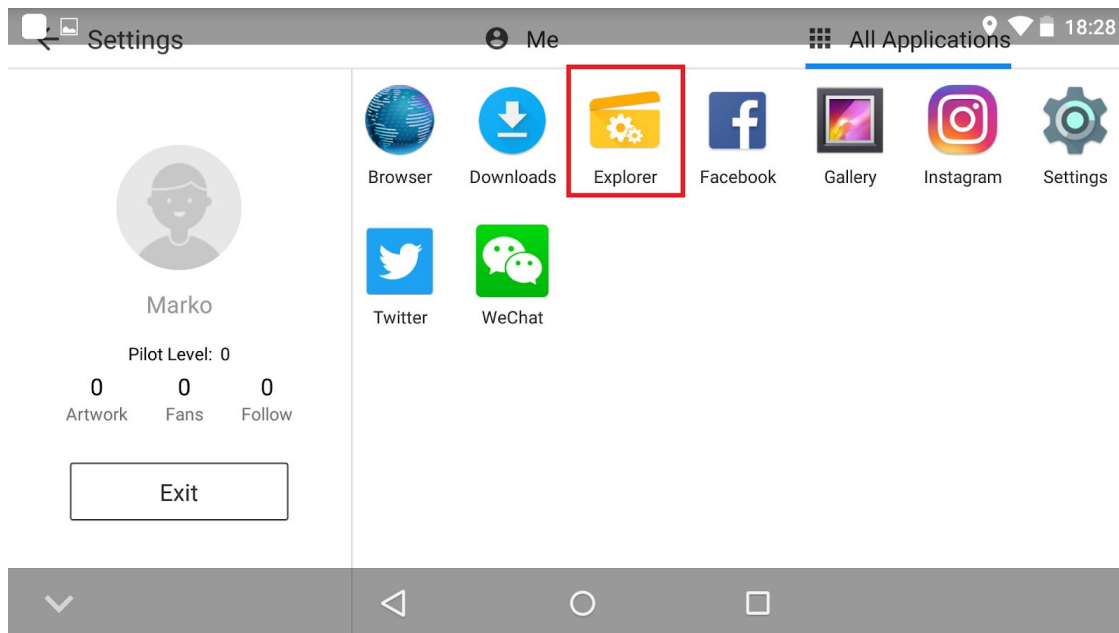

Select Internal memory:

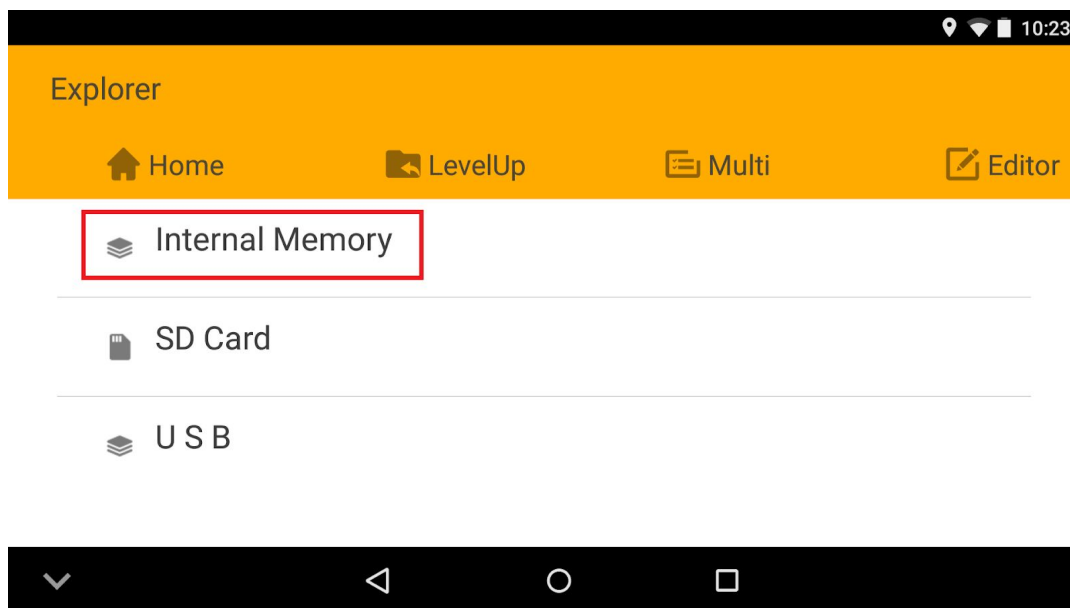

Select Download:

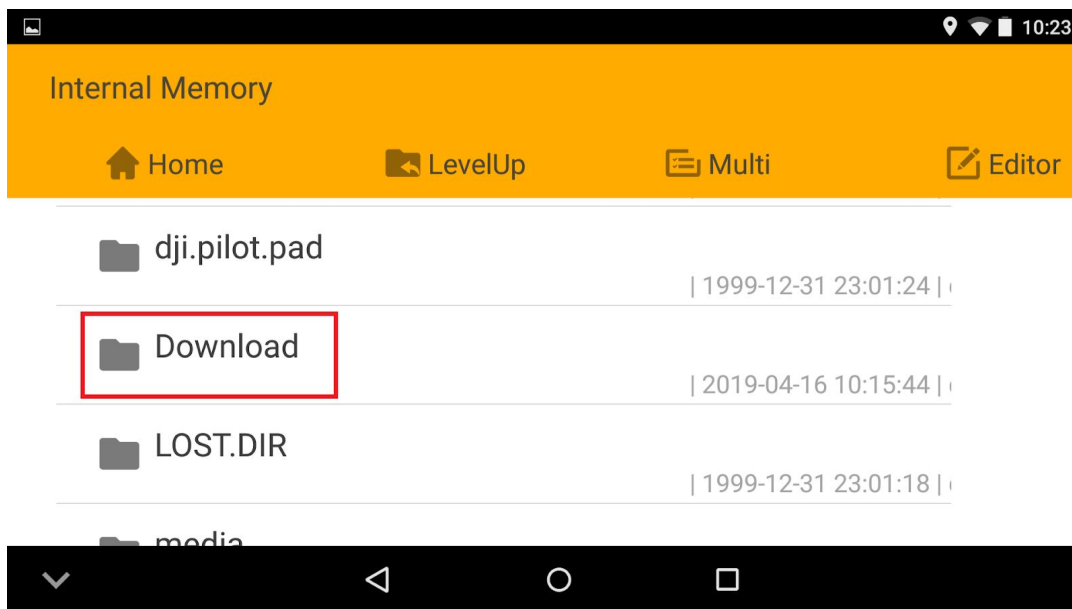

Click on 3DsurveyPilot.apk:

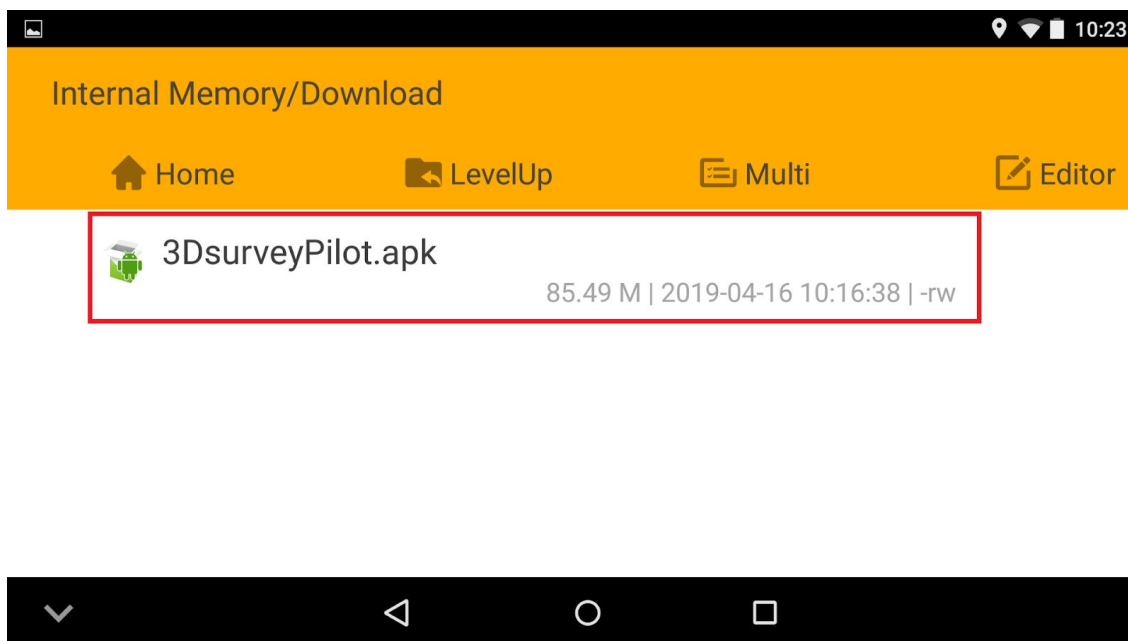

Select SETTINGS:

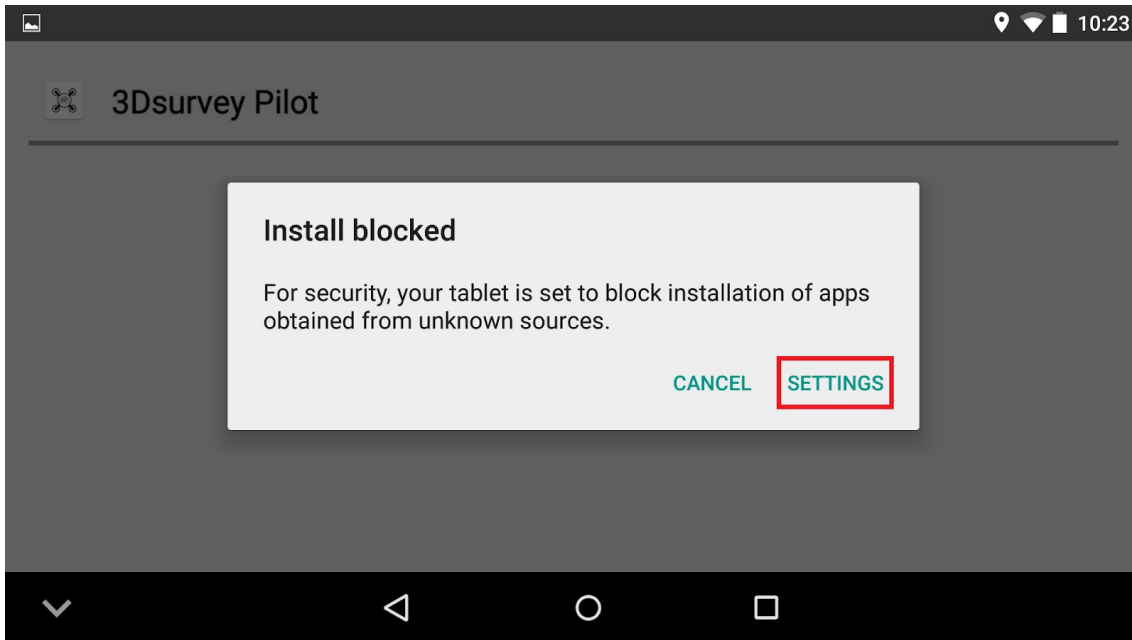

Set Unknown sources ON (slide to right):

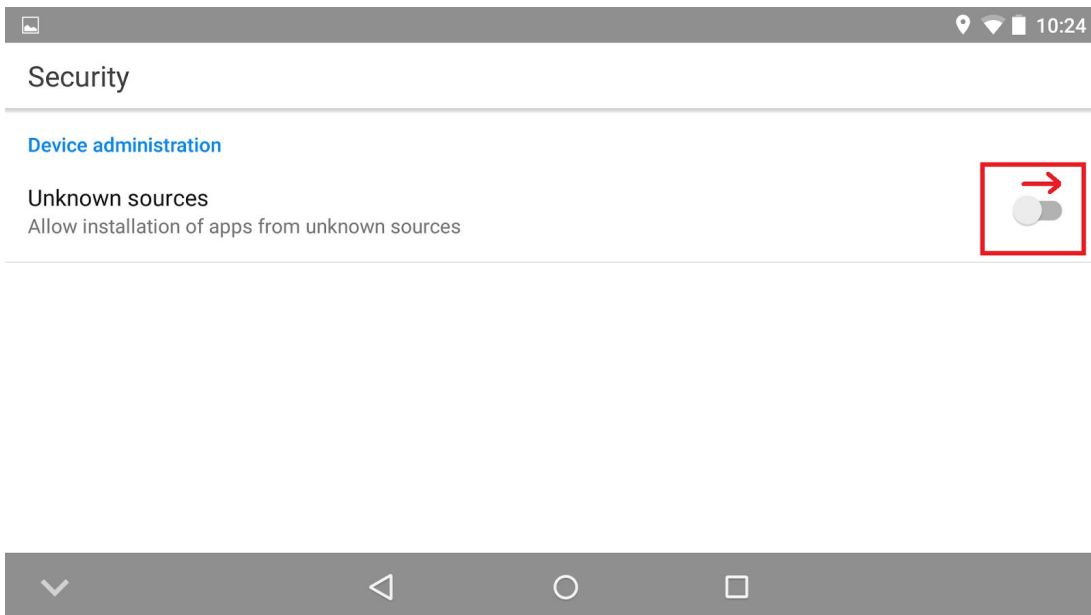

Click OK:

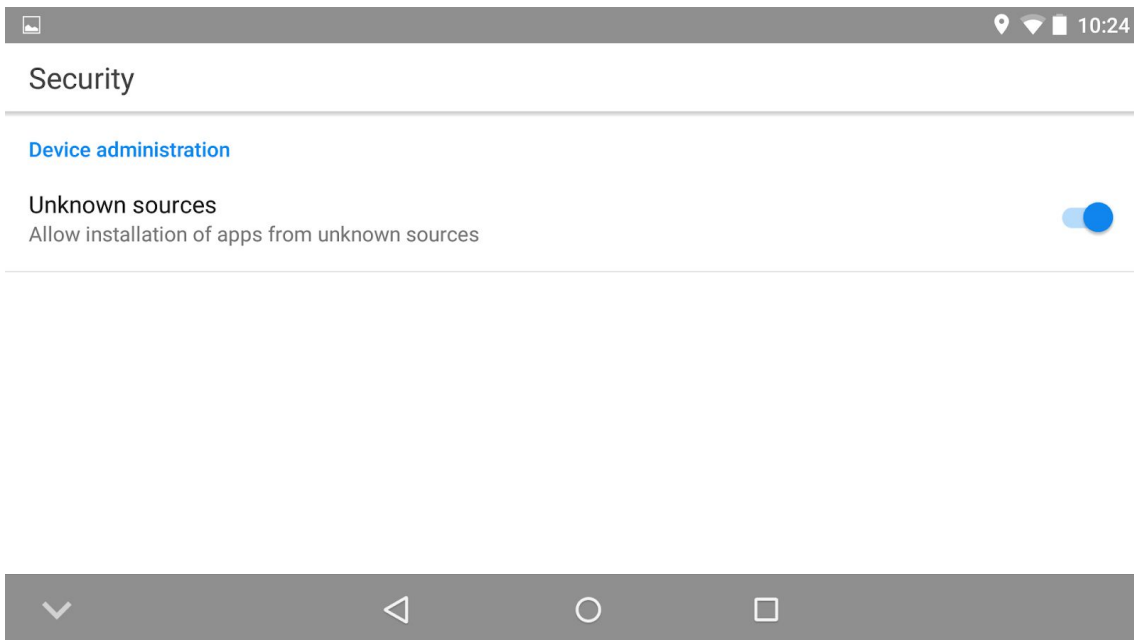
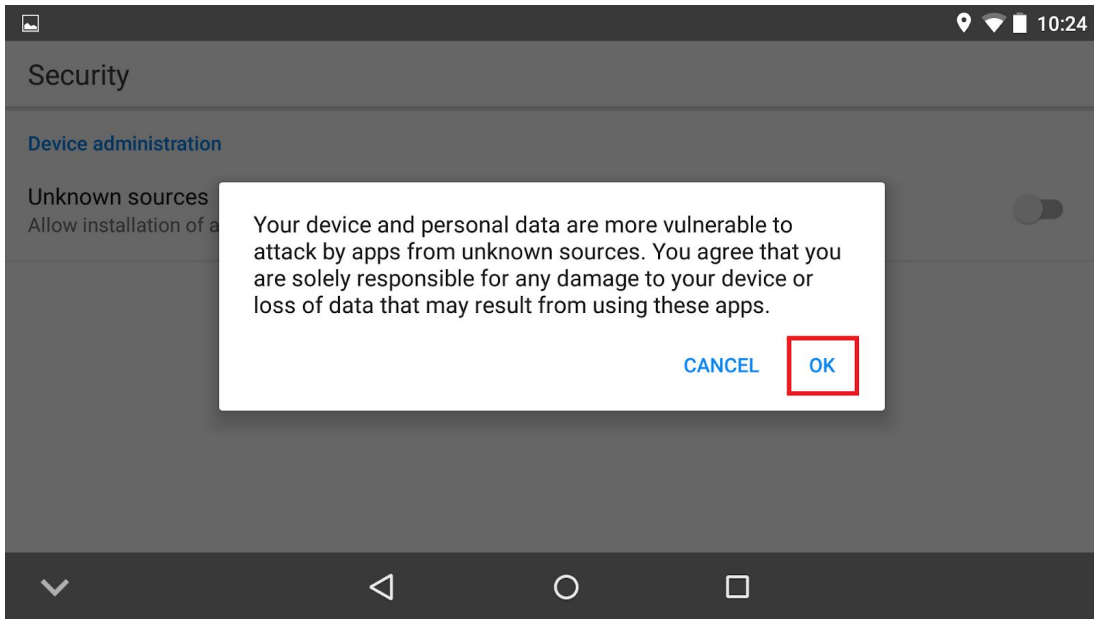

Go back to Explorer and to the 3DsurveyPilot.apk file. Click on file...

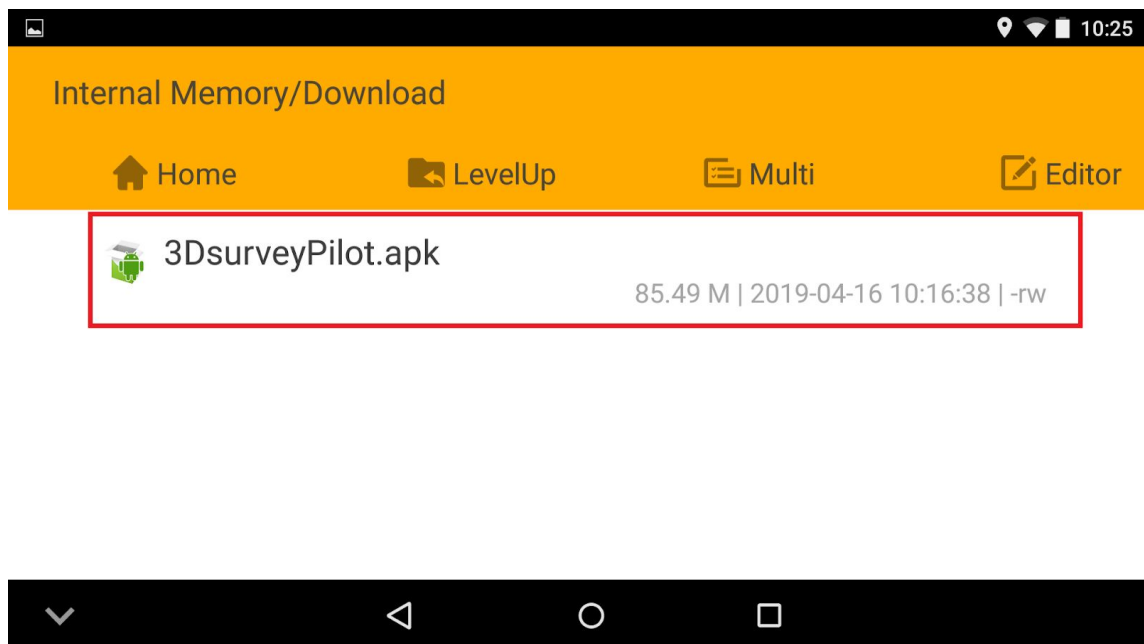

...and the Installation will start. Click on INSTALL:

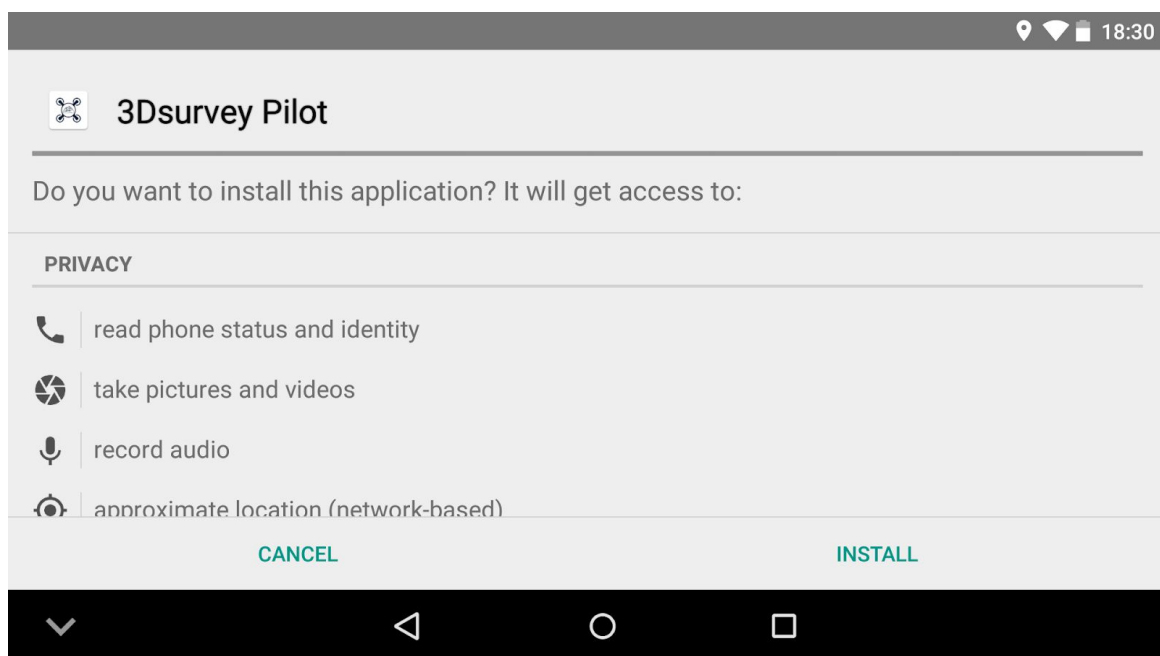



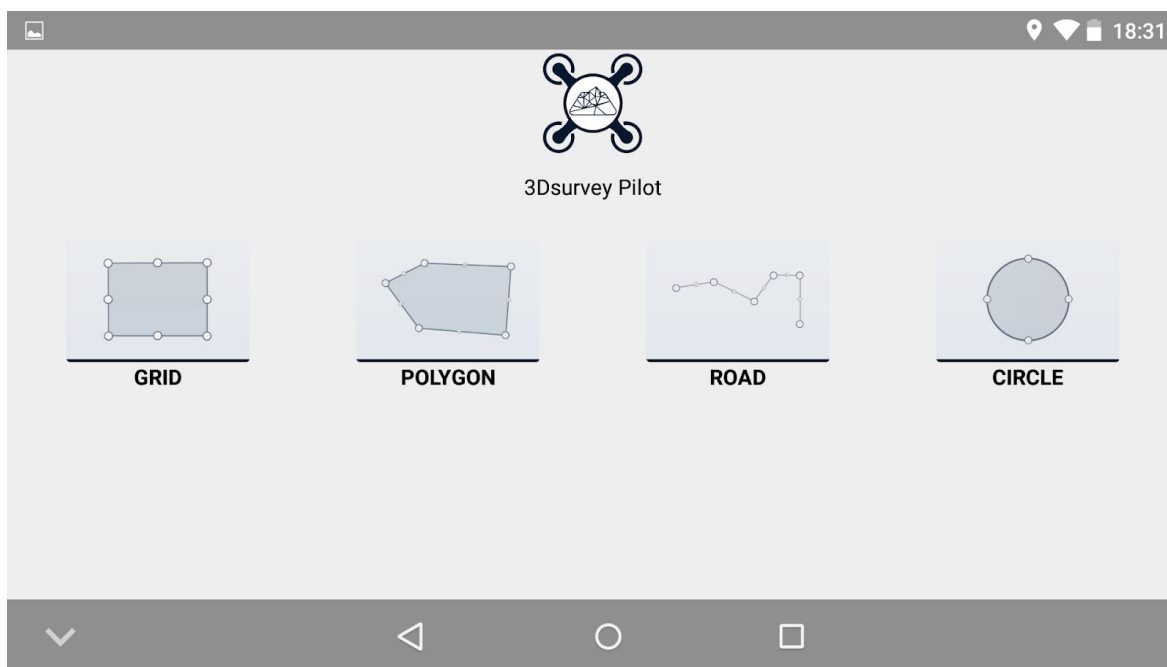
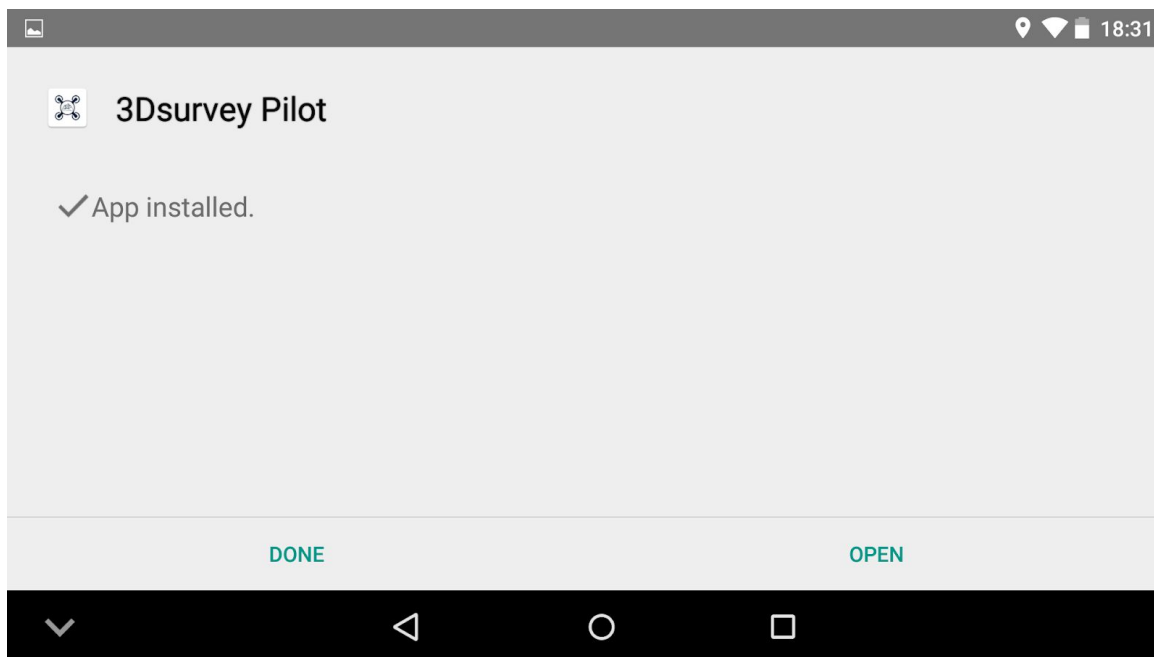

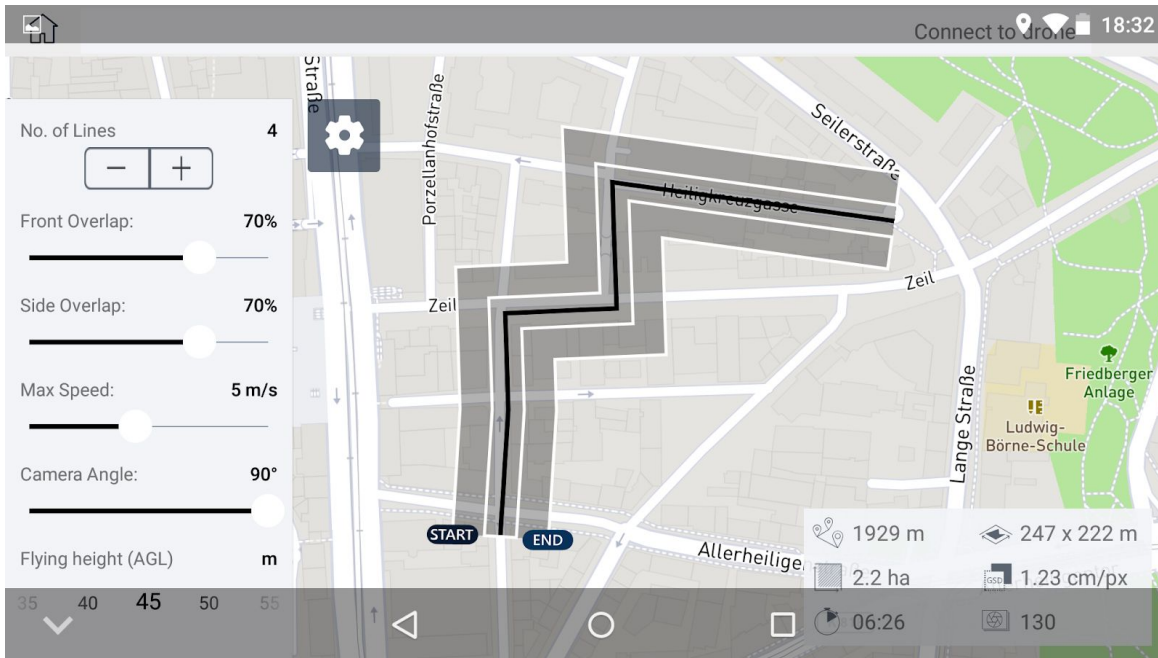

Save flight and happy 3Dsurveying:)